



Redefining automated sample processing

QIAcube® Connect – Gain more confidence with proven QIAGEN® technologies



Standardize your sample processing

The QIAcube Connect worktable

- ① Centrifuge for up to 12 samples
- ② 3 tip/enzyme racks for easy loading
- ③ Sample tube holder/shaker
- ④ Bottle racks for reagents
- ⑤ Robotic arm with sensors
- ⑥ UV light for decontamination

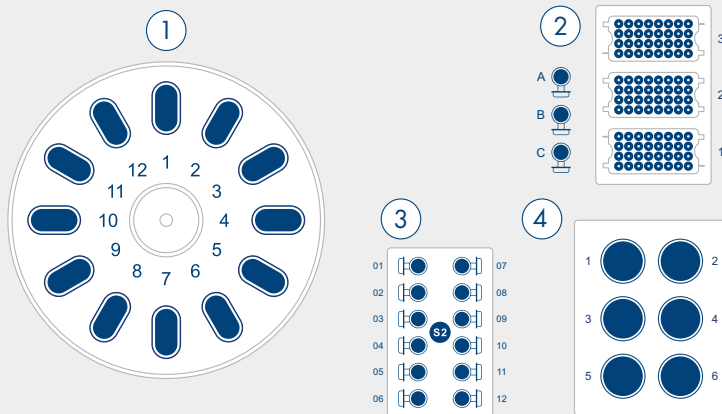

The Automation Process

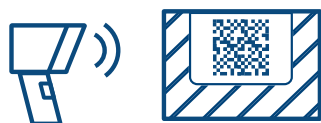

Scan kit bar code and sample IDs to import data

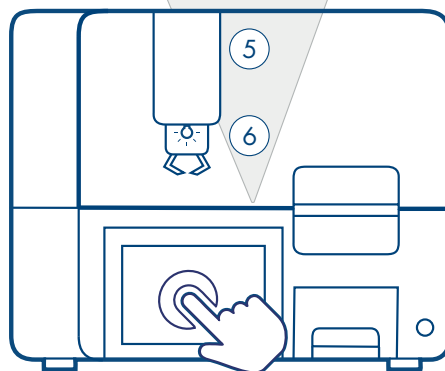

Use enhanced software for guided setup
Enjoy fully automated sample processing



Stay connected throughout the run



QIAcube Connect fully automates the lysis, bind, wash and elute steps of the QIAGEN gold standard spin columns for DNA, RNA and protein sample processing, with the power to automate over 80 kits and the ability to customize protocols.

With QIAcube Connect, researchers experience increased confidence in their valuable insights and can benefit from its high safety standards, built-in UV light for decontamination, advanced digital capabilities, sample tracking and pre-run checks for increased sample processing output and efficiencies.

This assures standardization and a seamless transition into the benefits of automation, freeing researchers from repetitive manual sample processing.

Stay connected with the QIAcube Connect tablet

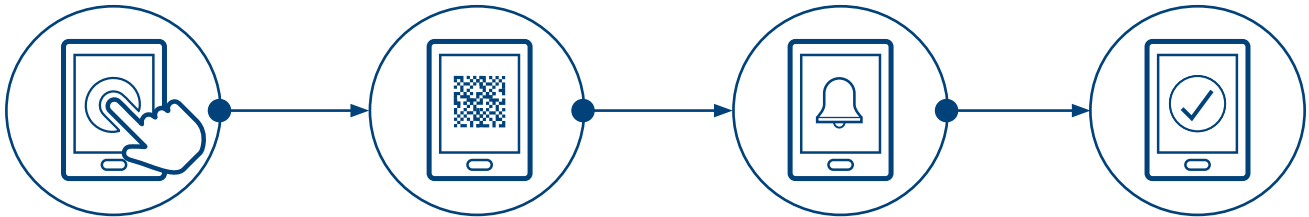

Guides run setup for all protocols at a click of a button

Scans kit bar codes and sample IDs for data import and process safety

Provides real-time run status with push notifications for complete runs and errors

Generates reports once run is complete

QIAcube Connect provides full connectivity with an augmented user interface that provides a new dimension of utility. You can stay connected to your QIAcube Connect via the built-in screen or remotely with a tablet (included), to enable quick response times and to monitor runs while away from the instrument.

Detailed instructions and guidelines facilitate a simple set-up process, reducing human error potential and streamlining sample tracking and user access management. QIAcube Connect empowers you to easily manage increasingly complex samples.



For more information, see our online demo at www.qiagen.com/QIAcubeConnect-demo



Simplify your workflow with the QIAcube Connect

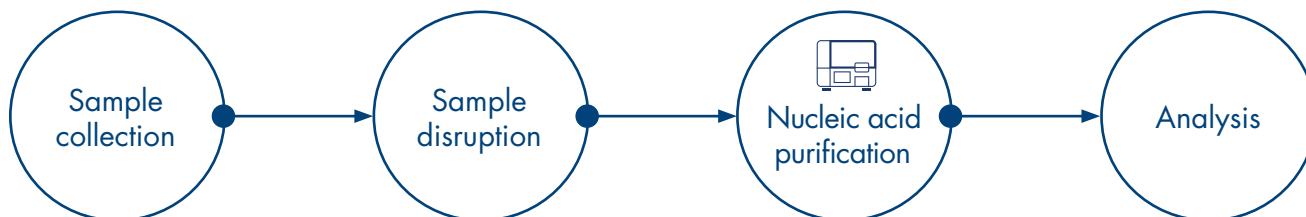

QIAcube has the power to automate over 80 QIAGEN kits with over 3000 protocols, empowering you to easily manage increasingly complex samples.

For more information on next-generation sample processing, visit www.qiagen.com/QIAcube-connect.

Ordering Information

Product	Contents	Cat. no.
QIAcube Connect*	Instrument, connectivity package, 1-year warranty on parts and labor	9002864
Starter Pack, QIAcube	Reagent bottle racks (3); 200 µl filter-tips (1024); 1000 µl filter-tips (1024); 30 ml reagent bottles (12); rotor adapters (240); rotor adapter holder	990395

* All QIAcube Connect instruments are provided with a region-specific connectivity package, including tablet and equipment necessary to connect to the local network. Further, QIAGEN offers comprehensive instrument service products, including service agreements, installation, introductory training and preventive subscription. Contact your local sales representative to learn about your options.

The QIAcube Connect is designed to perform fully automated purification of nucleic acids and proteins in molecular biology applications. The system is intended for use by professional users trained in molecular biological techniques and the operation of the QIAcube Connect.

For up-to-date licensing information and product-specific disclaimers, see the respective QIAGEN kit handbook or user manual. QIAGEN kit handbooks and user manuals are available at www.qiagen.com or can be requested from QIAGEN Technical Services or your local distributor.

Trademarks: QIAGEN®, Sample to Insight®, QIAcube® (QIAGEN Group).
PROM-14115-001 1117497 05/2019 © 2019 QIAGEN, all rights reserved.

Ordering www.qiagen.com/shop | Technical Support support.qiagen.com | Website www.qiagen.com